

NOTE:
 KNEE WALL/FENCE TO BE INSTALLED
 ALONG FOURAKER ROAD FRONTAGE.



CONNELLY & WICKER INC.
 10060 SKINNER LAKE DR, STE. 500
 JACKSONVILLE, FL 32246
 PHONE: (904) 265-3030
 FAX: (904) 265-3031
 www.cwieng.com ~ C.A. Number: 3650

FOURAKER SUBDIVISION

SITE PLAN REVISIONS
 JUNE 27, 2017
 Revised Exhibit 6

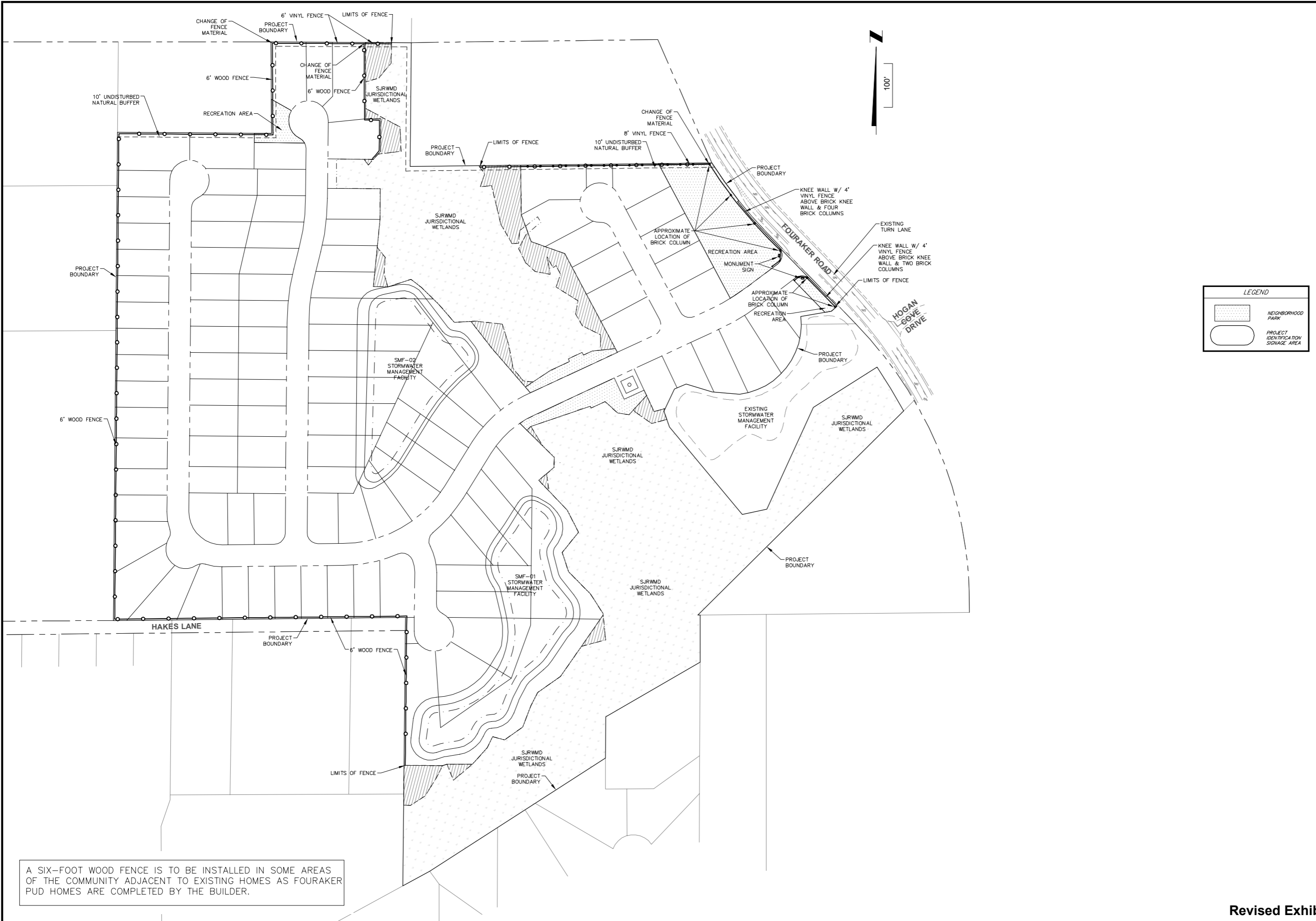

LEGEND

	NEIGHBORHOOD PARK
	PROJECT IDENTIFICATION SIGNAGE AREA

A SIX-FOOT WOOD FENCE IS TO BE INSTALLED IN SOME AREAS OF THE COMMUNITY ADJACENT TO EXISTING HOMES AS FOURAKER PUD HOMES ARE COMPLETED BY THE BUILDER.

Connelly & Wicker Inc.
 Planning · Engineering · Landscape Architecture
 10060 Shimmer Lake Drive, Suite 500 Jacksonville, Florida 32246
 (904) 265-3030 FAX: (904) 265-3031 www.cweng.com
 C.A. Number: 3650 L.A. Number: LC26000311

Revision	By	Date

**EXHIBIT M-
FENCING MAP**

FOURAKER SUBDIVISION
 DUVAL COUNTY, FL
 PREPARED FOR
LAND ROVER PROPERTIES, LLC

JUSTIN WILLIAMS, P.E.
 P.E. NO. 69260
 Reg. Engineer

Project No.: 17-01-0022	Designed: JEW	Drawn: JEW
Checked: TBW	O.C.: RCW	Date: JUNE 20, 2017
Scale: 1" = 100'		

THIS DRAWING IS THE PROPERTY OF CONNELLY & WICKER INC. AND IS NOT TO BE REPRODUCED OR COPIED IN WHOLE OR IN PART. IT IS NOT TO BE USED ON ANY OTHER PROJECT AND IS TO BE RETURNED ON REQUEST.

PVC Embossed Tru-Grain



Available in White (special order), Tan, Clay and Stone. Embossed design in Privacy and Ranch Rail. Rails, Pickets, u-channel, and posts are all embossed texture. Caps and accents are not embossed.

